

EN 1092-1 PN10 BLIND FLANGE DN65 — BORED FOR ANSI NPS 2-1/2" PIPE

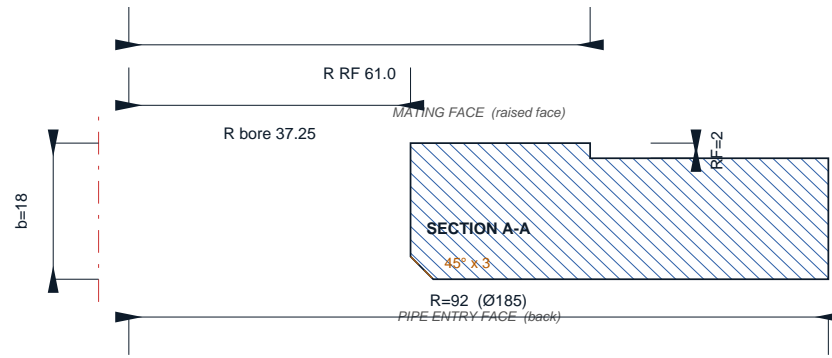
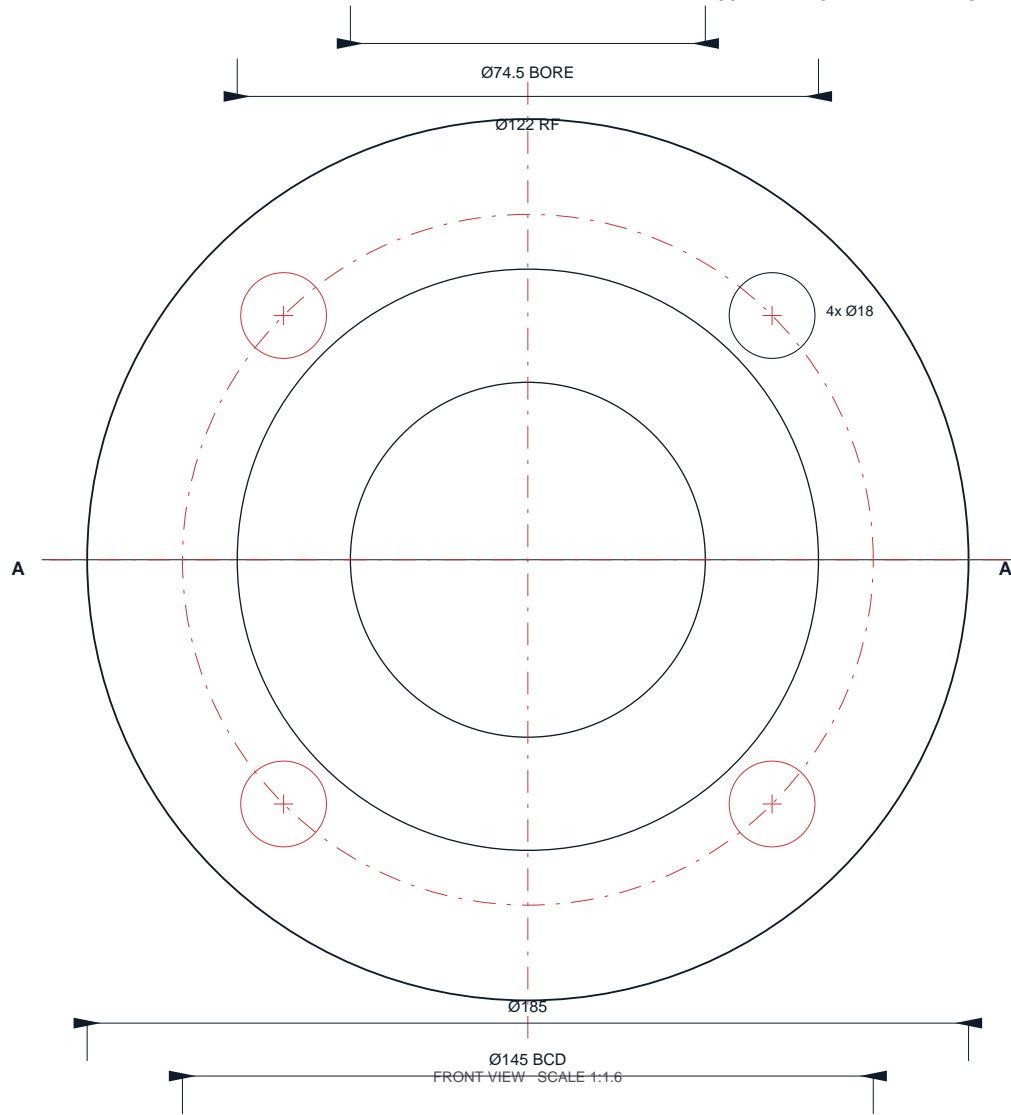

SECTION A-A SCALE 1:1

EN 1092-1 TYPE 05 | PN 10 | DN 65 | BORED TO SUIT ANSI/ASME NPS 2-1/2" (73.03 mm OD)

Sheet 1/6 Rev A

Flange OD	BCD (D1)	Bolt holes	Thickness b	RF OD (g)	RF height	Bore Ø	ANSI pipe OD	Clearance	Entry chamfer
185 mm	145 mm	4 x Ø18	18 mm	122 mm	2 mm	74.5 mm	73.03 mm	+1.5 mm	45° x 3 mm

STANDARD: EN 1092-1:2007+A1:2013 Type 05 Blind Flange, PN 10. BORE: Machined to ANSI/ASME B36.10M NPS 2-1/2" pipe OD 73.03 mm + 1.5 mm slip clearance. CHAMFER: 45° x 3 mm on pipe-entry face for fillet weld root access. RF OD 122 mm constant across all PN ratings for DN65 per EN 1092-1 Table 8. Verify minimum wall thickness at bore before machining. Rev A

EN 1092-1 PN16 BLIND FLANGE DN65 — BORED FOR ANSI NPS 2-1/2" PIPE

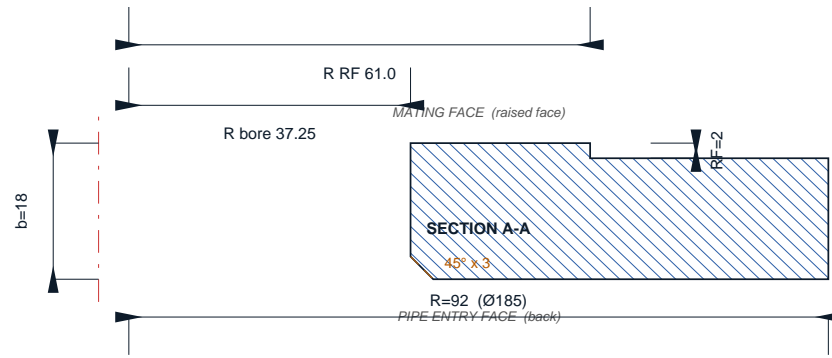
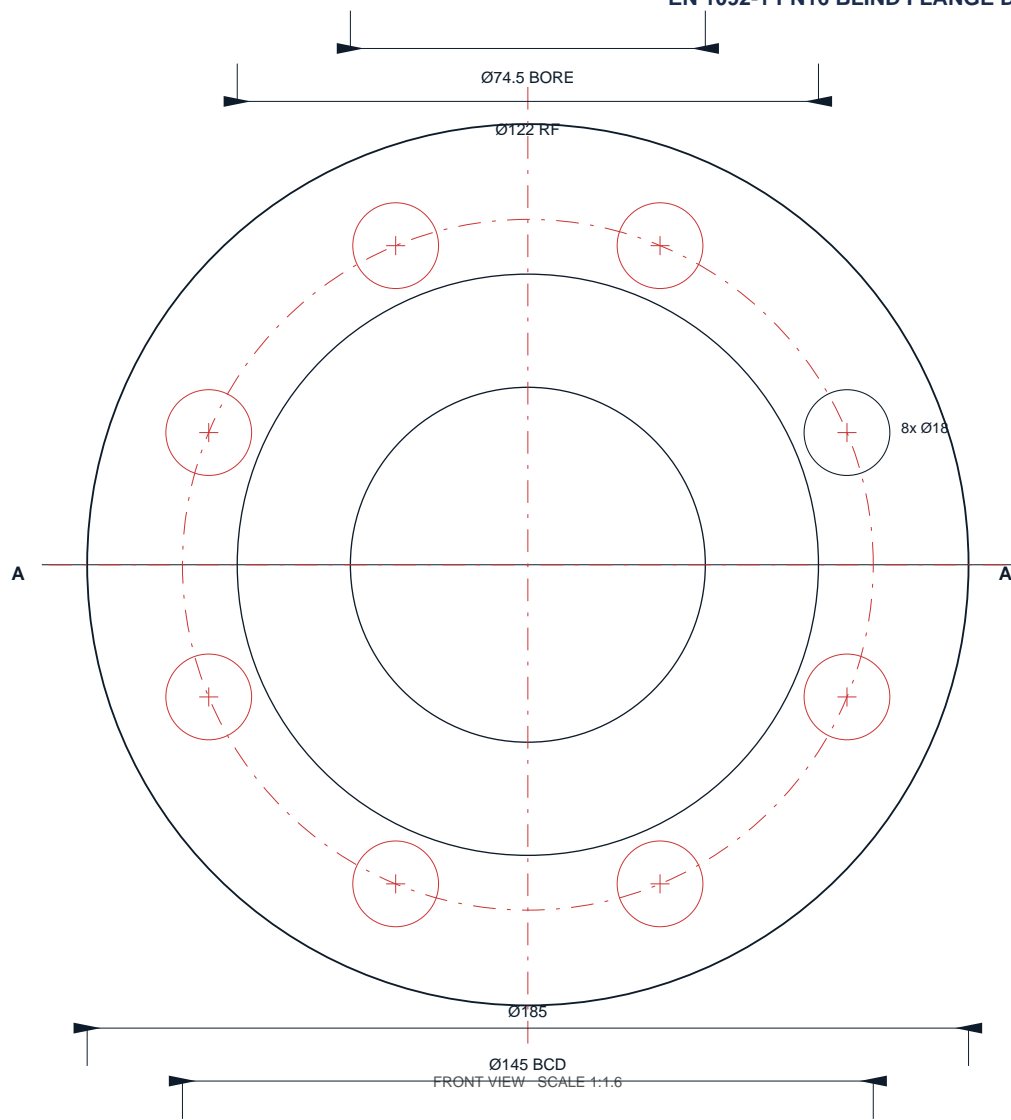

EN 1092-1 TYPE 05 | PN 16 | DN 65 | BORED TO SUIT ANSI/ASME NPS 2-1/2" (73.03 mm OD)

Sheet 2/6 Rev A

Flange OD	BCD (D1)	Bolt holes	Thickness b	RF OD (g)	RF height	Bore Ø	ANSI pipe OD	Clearance	Entry chamfer
185 mm	145 mm	8 x Ø18	18 mm	122 mm	2 mm	74.5 mm	73.03 mm	+1.5 mm	45° x 3 mm

STANDARD: EN 1092-1:2007+A1:2013 Type 05 Blind Flange, PN 16. BORE: Machined to ANSI/ASME B36.10M NPS 2-1/2" pipe OD 73.03 mm + 1.5 mm slip clearance. CHAMFER: 45° x 3 mm on pipe-entry face for fillet weld root access. RF OD 122 mm constant across all PN ratings for DN65 per EN 1092-1 Table 8. Verify minimum wall thickness at bore before machining. Rev A

EN 1092-1 PN25 BLIND FLANGE DN65 — BORED FOR ANSI NPS 2-1/2" PIPE

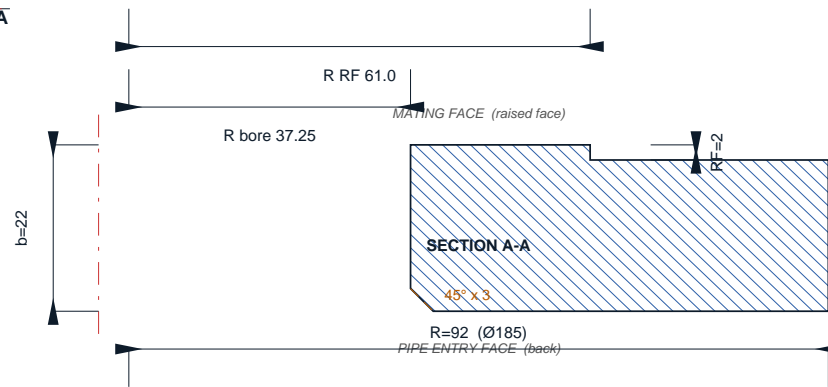
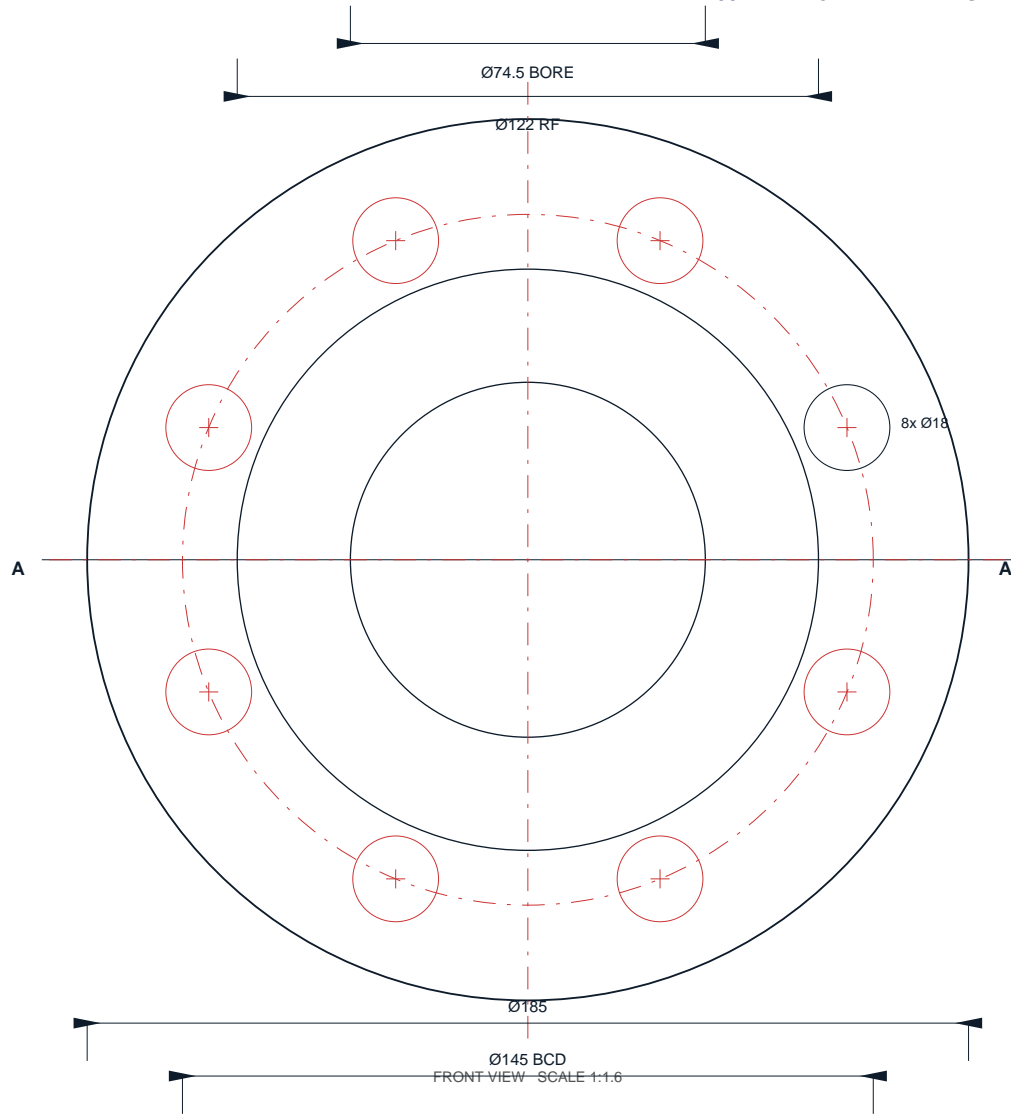

SECTION A-A SCALE 1:1

EN 1092-1 TYPE 05 | PN 25 | DN 65 | BORED TO SUIT ANSI/ASME NPS 2-1/2" (73.03 mm OD)

Sheet 3/6 Rev A

Flange OD	BCD (D1)	Bolt holes	Thickness b	RF OD (g)	RF height	Bore Ø	ANSI pipe OD	Clearance	Entry chamfer
185 mm	145 mm	8 x Ø18	22 mm	122 mm	2 mm	74.5 mm	73.03 mm	+1.5 mm	45° x 3 mm

STANDARD: EN 1092-1:2007+A1:2013 Type 05 Blind Flange, PN 25. BORE: Machined to ANSI/ASME B36.10M NPS 2-1/2" pipe OD 73.03 mm + 1.5 mm slip clearance. CHAMFER: 45° x 3 mm on pipe-entry face for fillet weld root access. RF OD 122 mm constant across all PN ratings for DN65 per EN 1092-1 Table 8. Verify minimum wall thickness at bore before machining. Rev A

EN 1092-1 PN40 BLIND FLANGE DN65 — BORED FOR ANSI NPS 2-1/2" PIPE

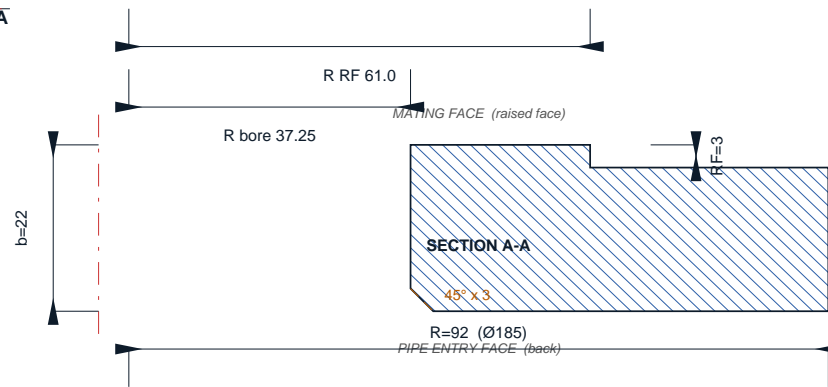
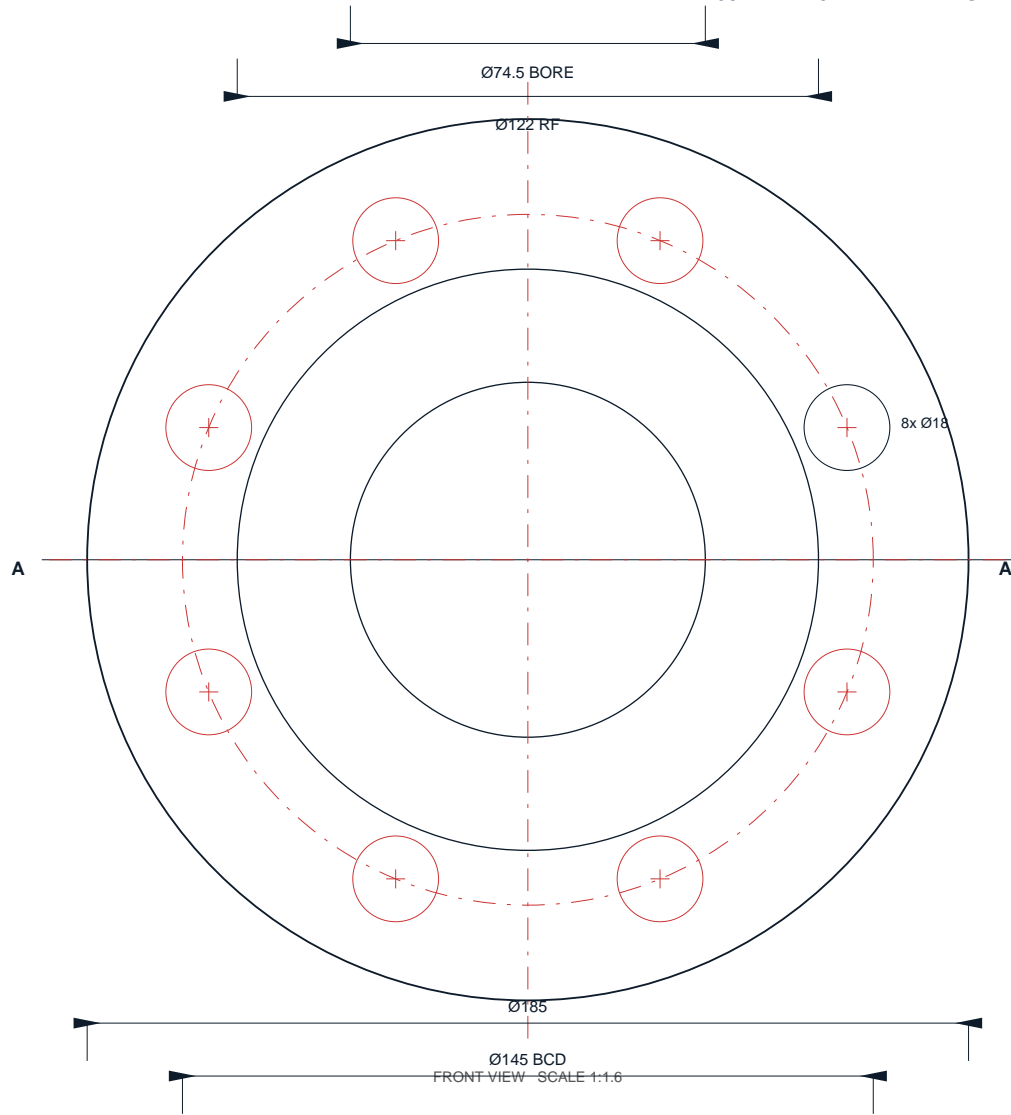

SECTION A-A SCALE 1:1

EN 1092-1 TYPE 05 | PN 40 | DN 65 | BORED TO SUIT ANSI/ASME NPS 2-1/2" (73.03 mm OD)

Sheet 4/6 Rev A

Flange OD	BCD (D1)	Bolt holes	Thickness b	RF OD (g)	RF height	Bore Ø	ANSI pipe OD	Clearance	Entry chamfer
185 mm	145 mm	8 x Ø18	22 mm	122 mm	3 mm	74.5 mm	73.03 mm	+1.5 mm	45° x 3 mm

STANDARD: EN 1092-1:2007+A1:2013 Type 05 Blind Flange, PN 40. BORE: Machined to ANSI/ASME B36.10M NPS 2-1/2" pipe OD 73.03 mm + 1.5 mm slip clearance. CHAMFER: 45° x 3 mm on pipe-entry face for fillet weld root access. RF OD 122 mm constant across all PN ratings for DN65 per EN 1092-1 Table 8. Verify minimum wall thickness at bore before machining. Rev A

EN 1092-1 PN63 BLIND FLANGE DN65 — BORED FOR ANSI NPS 2-1/2" PIPE

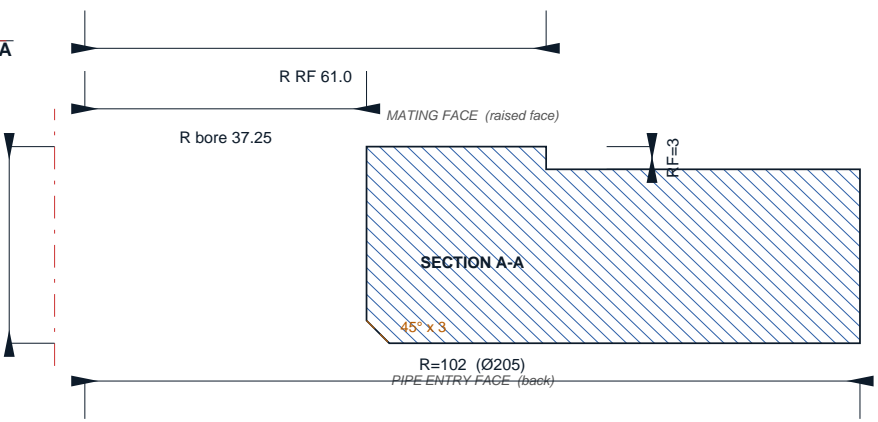
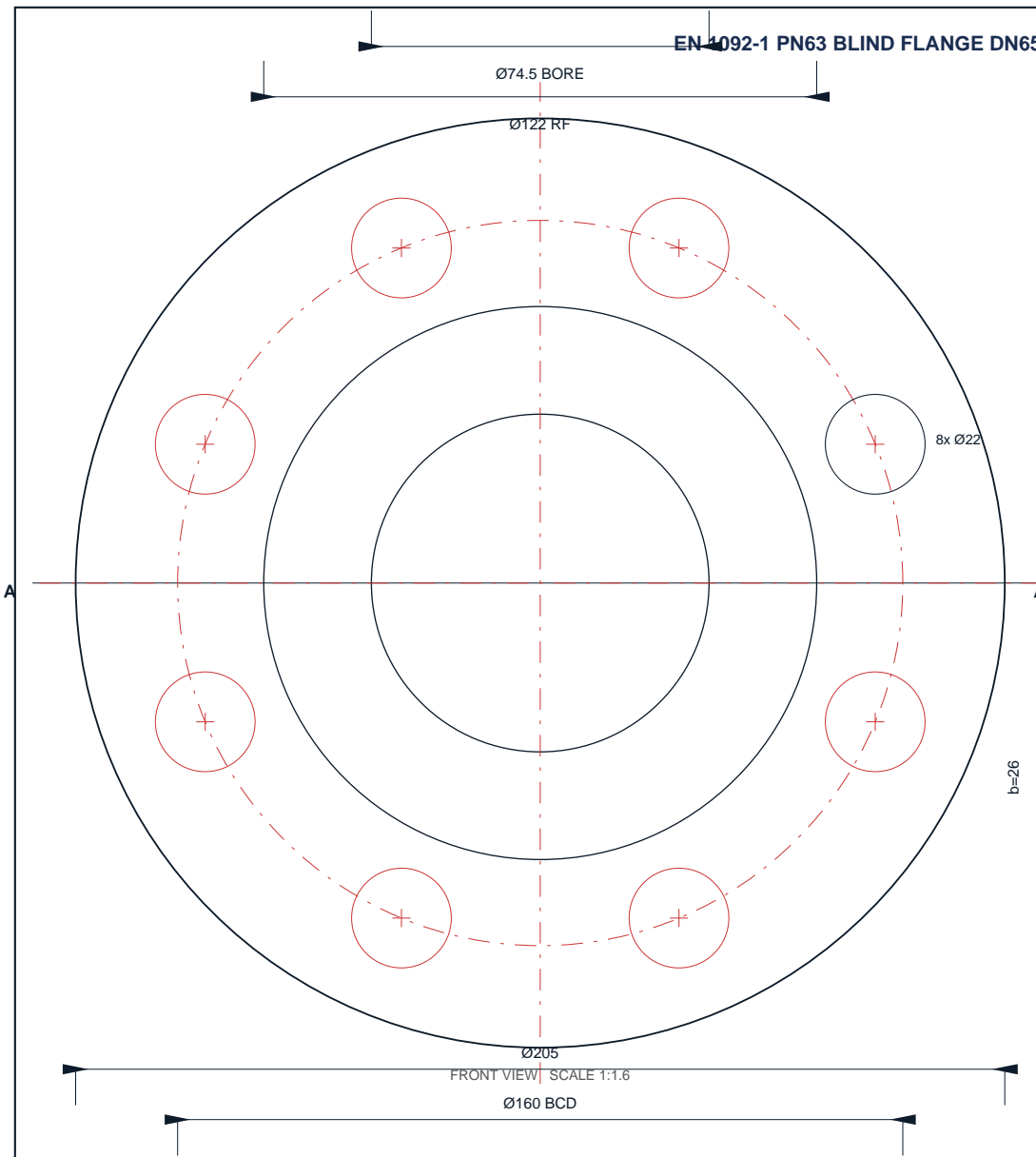

SECTION A-A SCALE 1:1

EN 1092-1 TYPE 05 | PN 63 | DN 65 | BORED TO SUIT ANSI/ASME NPS 2-1/2" (73.03 mm OD) Sheet 5/6 Rev A

Flange OD	BCD (D1)	Bolt holes	Thickness b	RF OD (g)	RF height	Bore Ø	ANSI pipe OD	Clearance	Entry chamfer
205 mm	160 mm	8 x Ø22	26 mm	122 mm	3 mm	74.5 mm	73.03 mm	+1.5 mm	45° x 3 mm

STANDARD: EN 1092-1:2007+A1:2013 Type 05 Blind Flange, PN 63. BORE: Machined to ANSI/ASME B36.10M NPS 2-1/2" pipe OD 73.03 mm + 1.5 mm slip clearance. CHAMFER: 45° x 3 mm on pipe-entry face for fillet weld root access. RF OD 122 mm constant across all PN ratings for DN65 per EN 1092-1 Table 8. Verify minimum wall thickness at bore before machining. Rev

Ø74.5 BORE EN 1092-1 PN100 BLIND FLANGE DN65 — BORED FOR ANSI NPS 2-1/2" PIPE

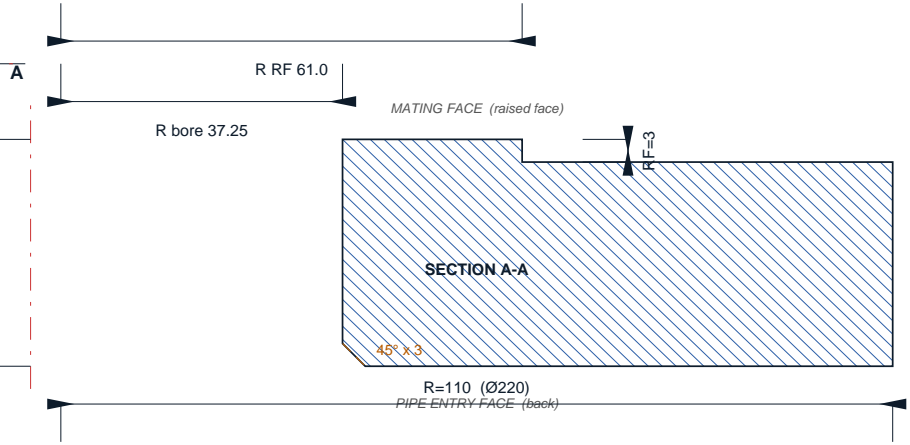
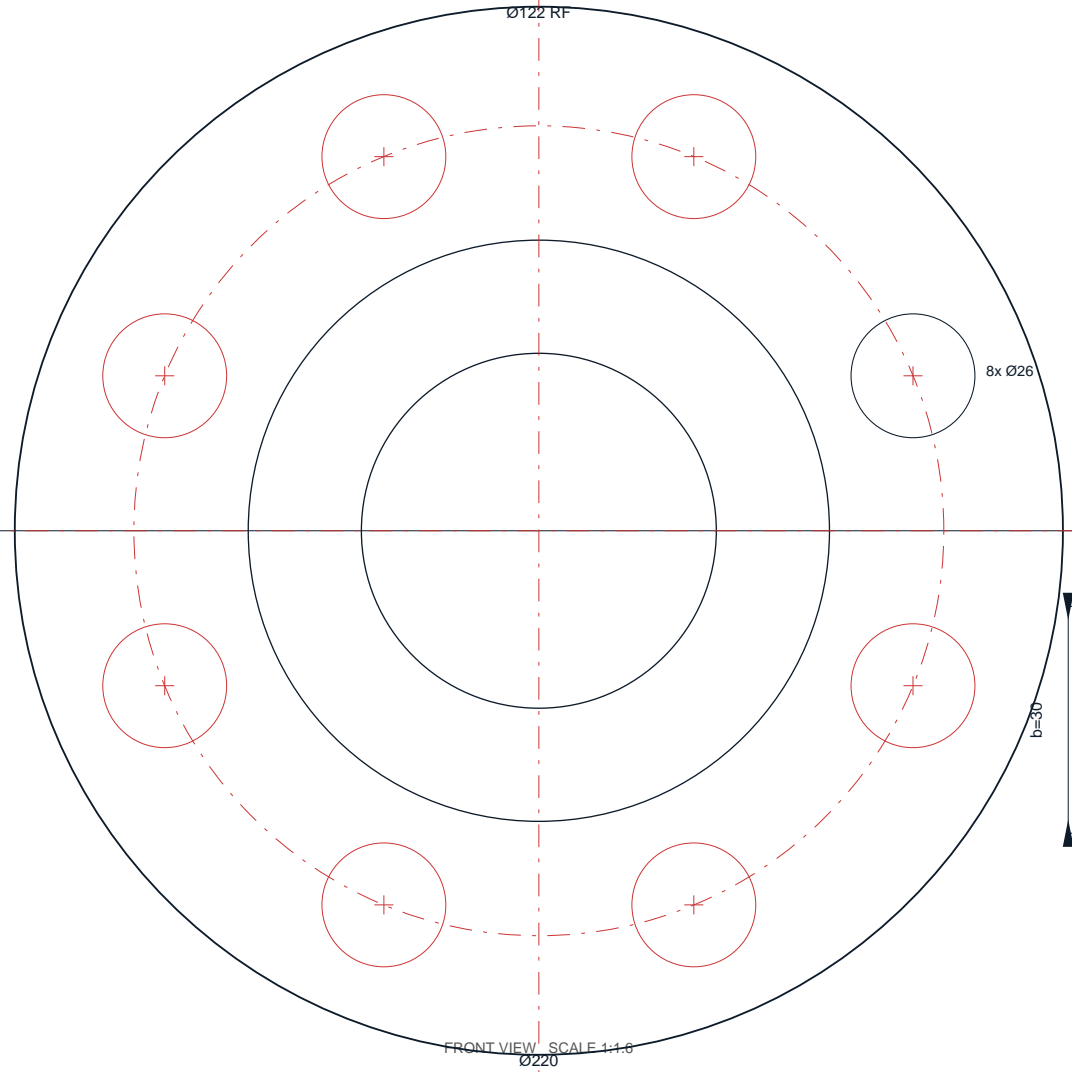

SECTION A-A SCALE 1:1

EN 1092-1 TYPE 05 | PN 100 | DN 65 | BORED TO SUIT ANSI/ASME NPS 2-1/2" (73.03 mm OD)

Sheet 6/6 Rev A

Flange OD	BCD (D1)	Bolt holes	Thickness b	RF OD (g)	RF height	Bore Ø	ANSI pipe OD	Clearance	Entry chamfer
220 mm	170 mm	8 x Ø26	30 mm	122 mm	3 mm	74.5 mm	73.03 mm	+1.5 mm	45° x 3 mm

STANDARD: EN 1092-1:2007+A1:2013 Type 05 Blind Flange, PN 100. BORE: Machined to ANSI/ASME B36.10M NPS 2-1/2" pipe OD 73.03 mm + 1.5 mm slip clearance. CHAMFER: 45° x 3 mm on pipe-entry face for fillet weld root access. RF OD 122 mm constant across all PN ratings for DN65 per EN 1092-1 Table 8. Verify minimum wall thickness at bore before machining.